

HOW TO DOWNLOAD A DOCUMENT FROM WEBSITE

1. Click

Download

QUARTERLY REPORT FILLABLE.pdf
stet Oct 6, 2022 by Kentucky Family Planning

RESET

Kentucky Family Planning TITLE X FAMILY PLANNING QUARTERLY REPORT



Agency Name _____ Date _____
Time period of report: JAN 1 – MAR 31 (Due Apr 14th) APR 1 – JUN 30 (Due Jul 14th)
 JUL 1 – SEP 30 (Due Oct 14th) OCT 1 – DEC 31 (Due Jan 14th)

Submit Quarterly Report to WomensHealthInvoices@ky.gov

Number of Family Planning Encounters: _____ Unduplicated Clients: _____
INCENTIVE Type: _____ (# per item) _____ # purchased: _____ # distributed: _____

Submit each of following twice a year: Outreach, and Budget Expense Report

OUTREACH ACTIVITY YES, details below Plan later date NA

Date(s) of activity: _____ Hours of activity: _____ Targeted County: _____

Activity type: _____ Location/Venue of activity: _____ Estimate prep time: _____

Population activity intended to reach: _____ Number of people reached: _____

Description/Purpose of event: _____

Evaluation of Success: _____

Feedback of participants/staff: _____

Title X Family Planning Budget Expense Attached: YES NO

Submit each of following once a year: Quality Improvement Project, I&E Meeting, CPEP Discussed or Reviewed.

QUALITY IMPROVEMENT PROJECT: Initiated In-Progress Completed NA

Expected date of completion: _____ Describe Goal: _____

Open Download Share X

Size: 147.3 KB

Add Task

Kentucky Family Planning uploaded v1 - 2

Write a comment

@mention users to notify them.

2. You may see the following window pop up. **Disregard** and go to your "Downloads" file on your computer

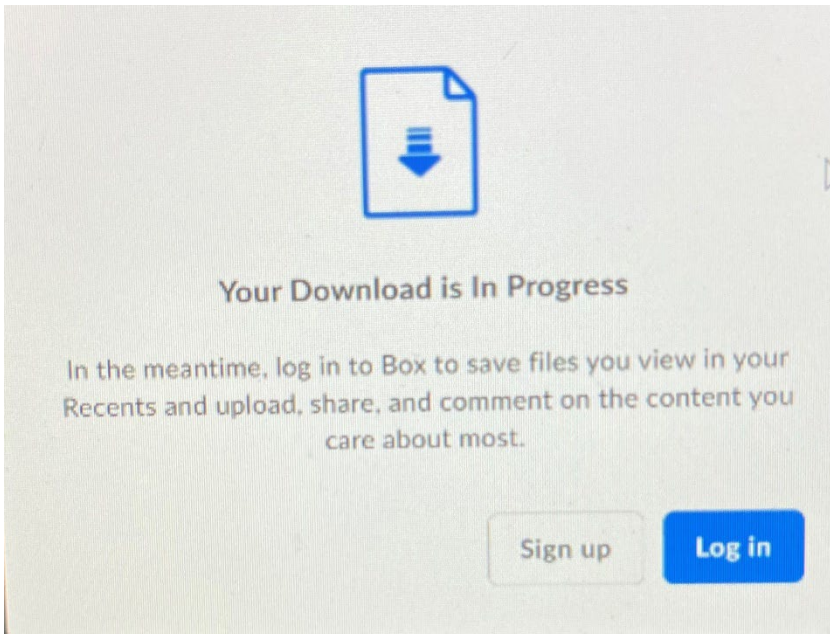

3. To find your Downloads file go to the  (search) at bottom of computer and type in "File" as noted below. Click on the "File Explorer" icon

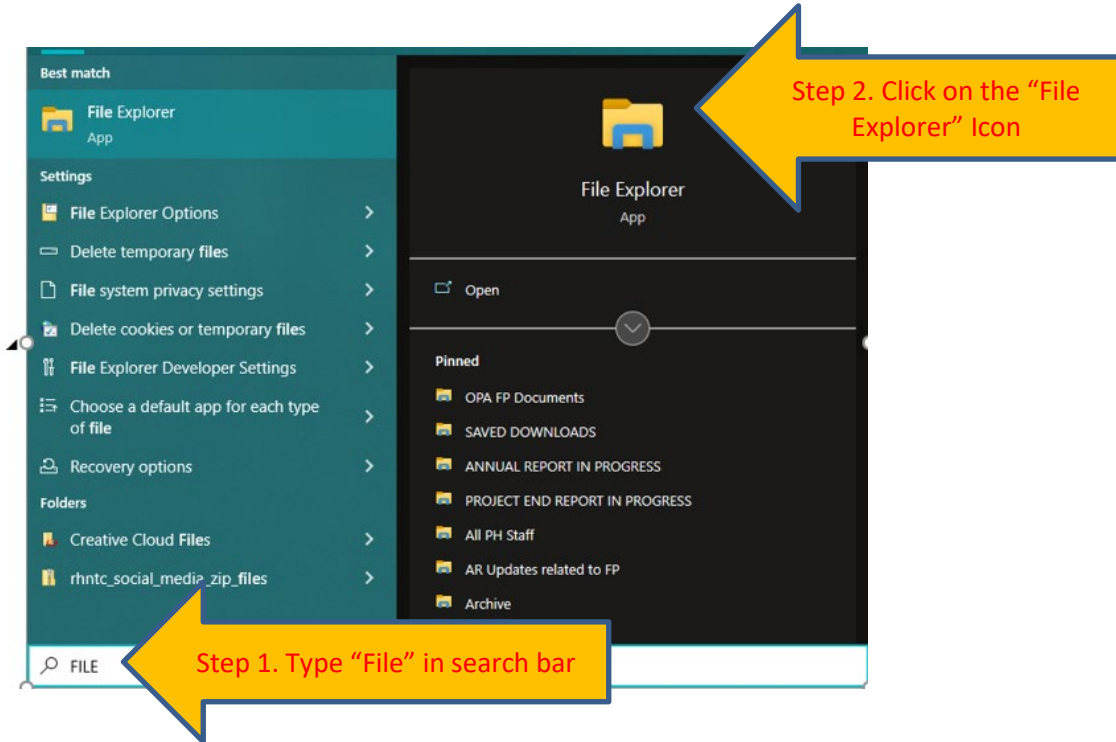

4. Click on your "Downloads" file

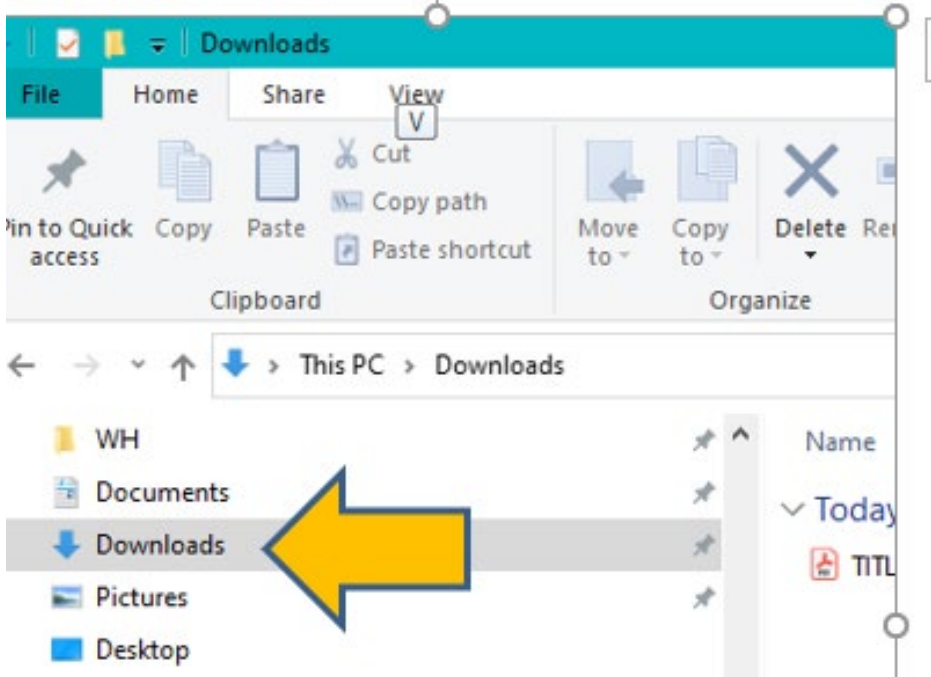

5. Click on “Title X KFP Quarterly Report Fillable”

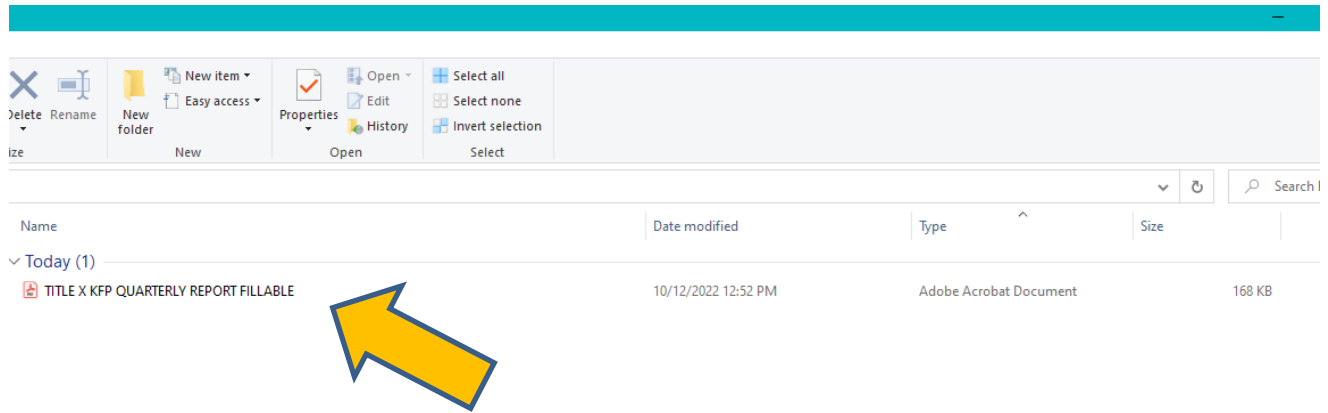

6. If you have further problems, contact your computer staff or email FamilyPlanning@ky.gov.