

## Mobile Caregiver+ Quick Reference Guide Report a Missing Address to Google Maps

The Mobile Caregiver+ app uses Google Maps to verify the start location and end location of waiver services. If the address of the service is missing from Google Maps, the Mobile Caregiver+ app will have trouble finding it. If this occurs, you can report the address to Google and have it added to Google Maps using the following steps.

- 1) Go to Google Maps at <https://www.google.com/maps>.
- 2) Locate the address in Google Maps. There are several different ways to do this.
  - a) Try typing the full address in the search bar to see if Google Maps can find it. If searching for the full address does not work, try searching the street name only.
  - b) Search for a location by using longitude and latitude. You can use either of the following notation styles.
    - i. 40°30'40.8"N 98°24'32.8"W
    - ii. 40.511328, -98.409108

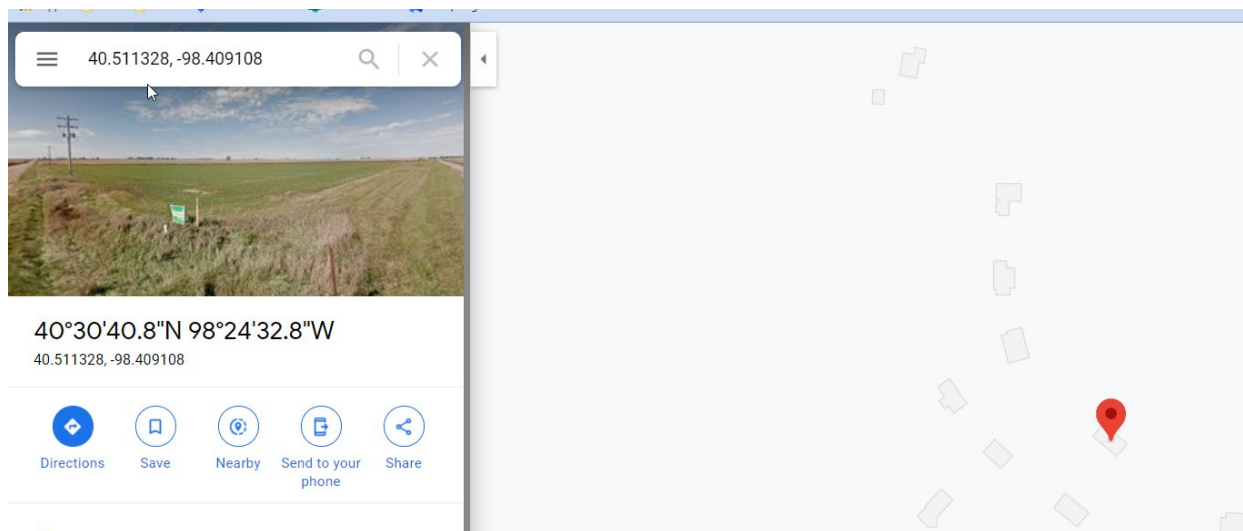

## Mobile Caregiver+ Quick Reference Guide Report a Missing Address to Google Maps

- c) Find the location on the map manually the click twice to drop a pin.

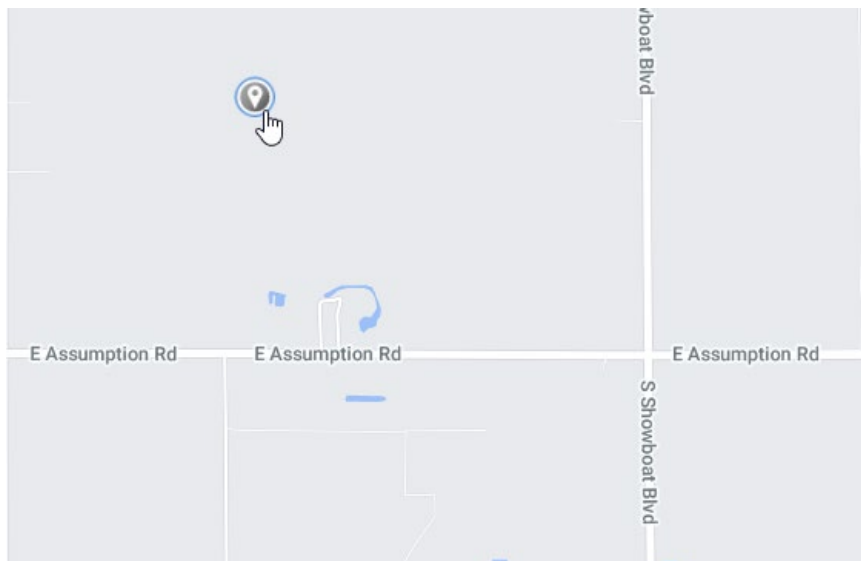

- 3) Once you have found the address on the map, click the **Send Feedback** link on the lower left-hand side of the screen.

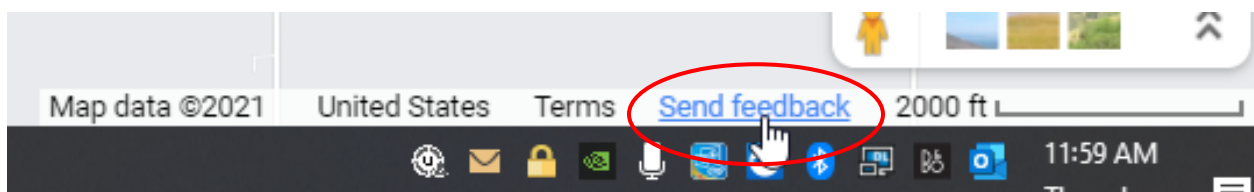

- 4) Click **Add Missing Address**. Enter the full address and use Update Location on Map to adjust the location as needed.

## Mobile Caregiver+ Quick Reference Guide Report a Missing Address to Google Maps

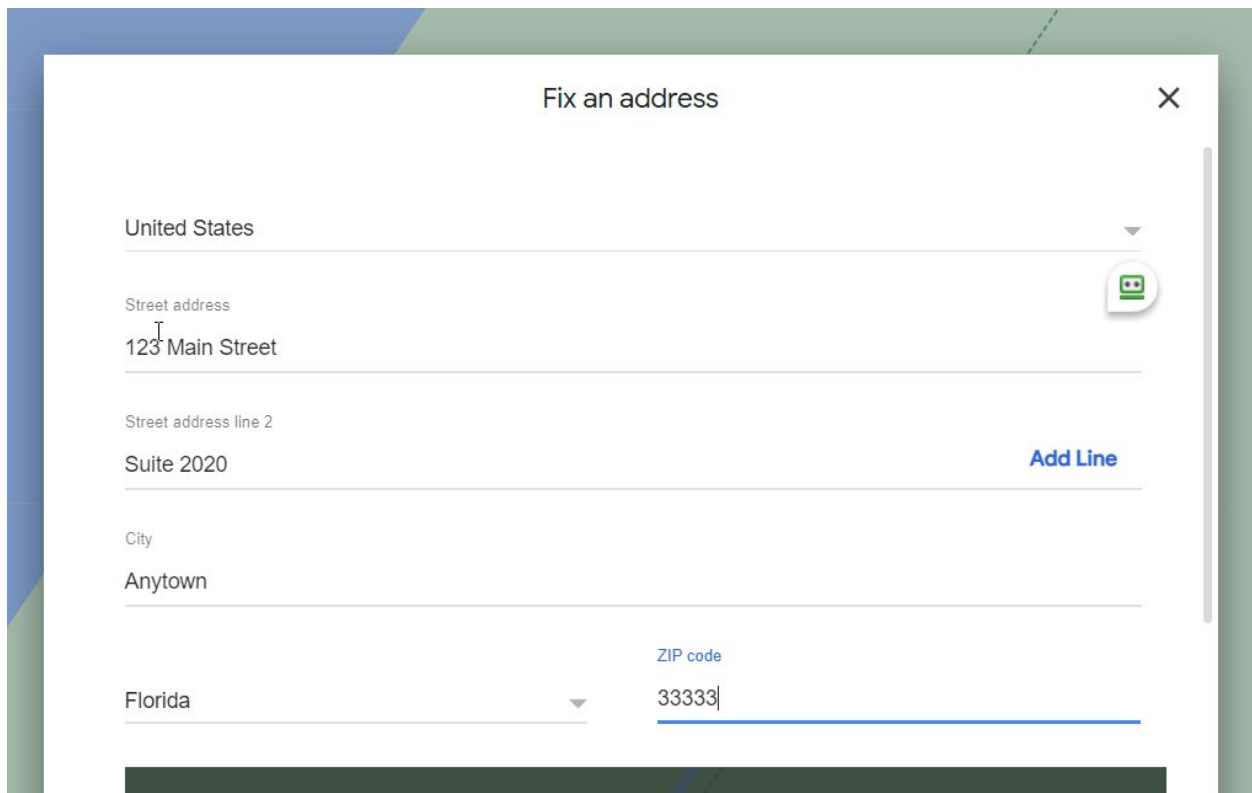
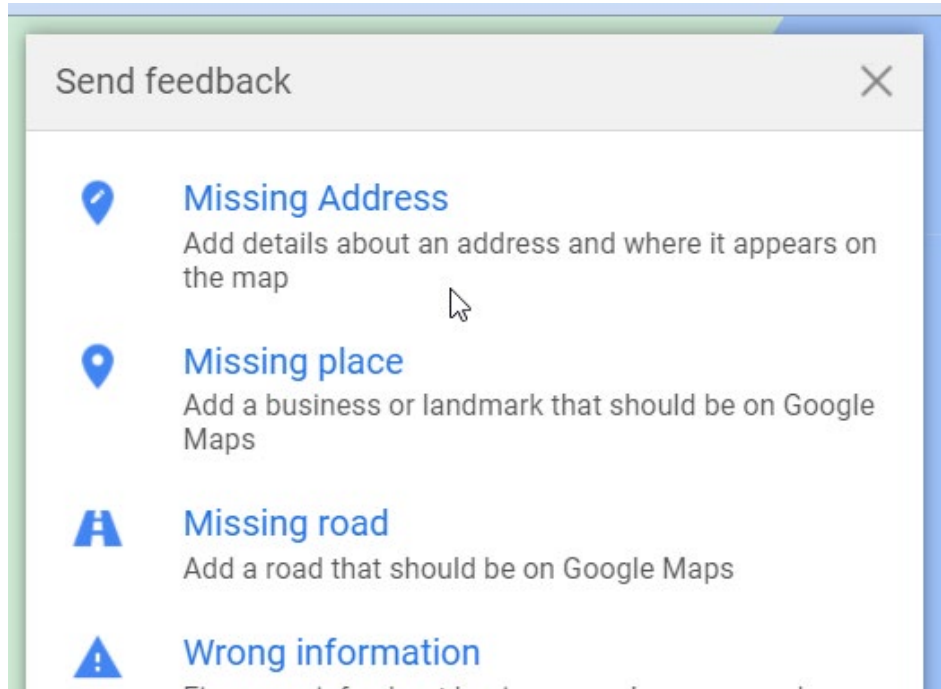

## Mobile Caregiver+ Quick Reference Guide Report a Missing Address to Google Maps

5) Select a reason for the change from the dropdown menu.

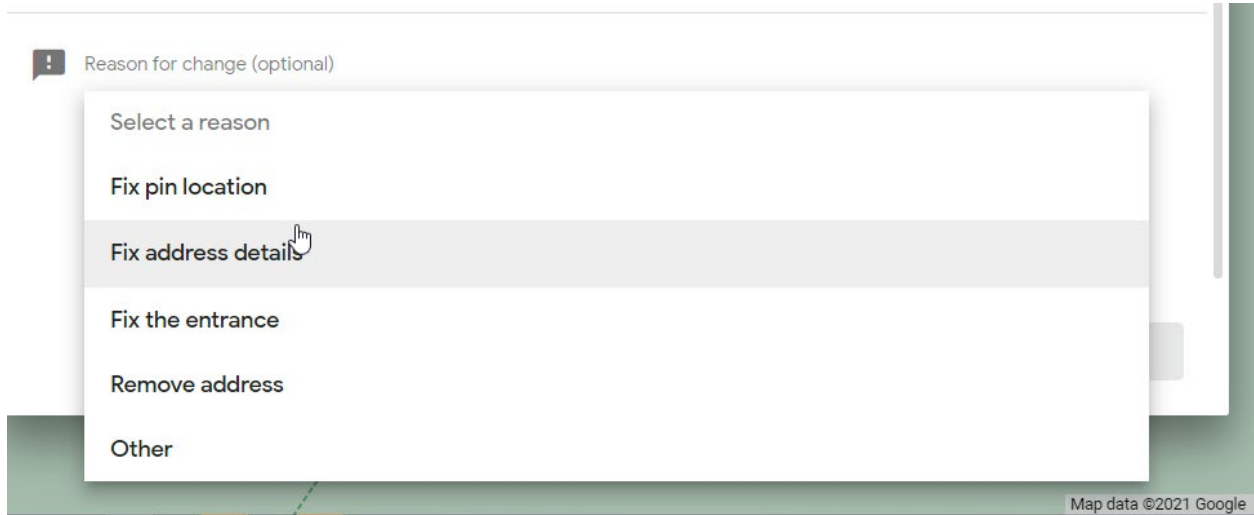

6) Click **Send**. Google will verify the address and update its map.

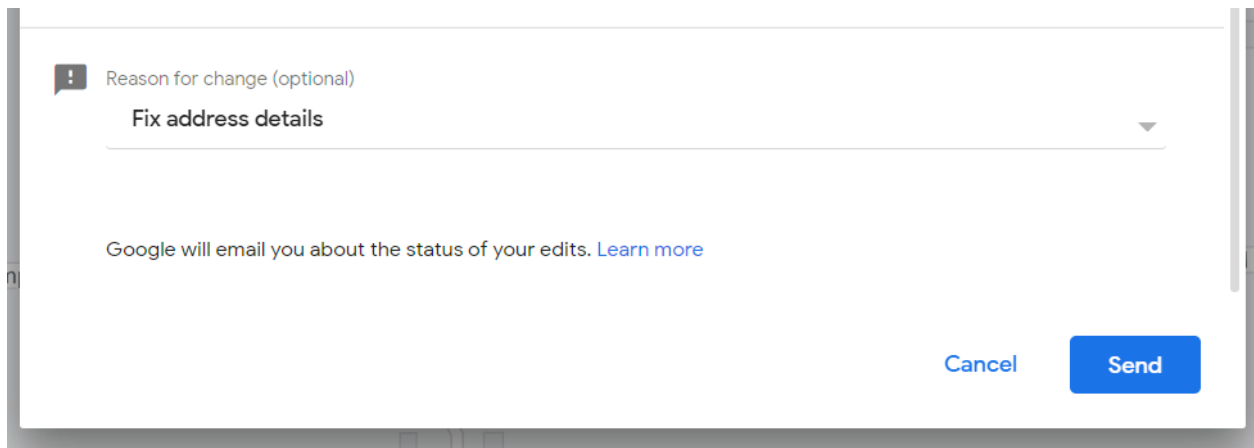

### Additional Resources



A complete list of EVV resources is available in the [EVV QRG: Who to Call](#) listing, on the DMS EVV website at <https://bit.ly/kywaiverEVVinfo>, or by scanning the QR code to the left using your mobile device.

**Mobile Caregiver+ Quick Reference Guide  
Report a Missing Address to Google Maps**

